

INDUSTRY NINE STEM INSTALL GUIDE

Industry Nine highly recommends that a qualified bicycle technician install your stem to ensure proper fit and torque.

Read all steps before beginning installation.

Please refer to your fork and handlebar manufacturers' recommended installation specifications.

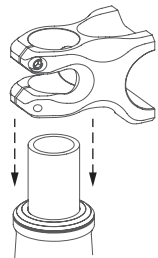

1 Slide stem body onto steerer tube.

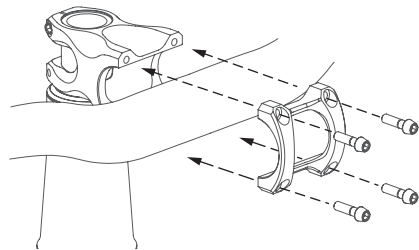

2 Thread faceplate bolts into stem until snug.

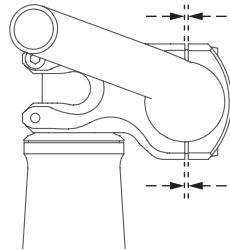

3 Ensure the gap is even on top and bottom between the faceplate and stem body.

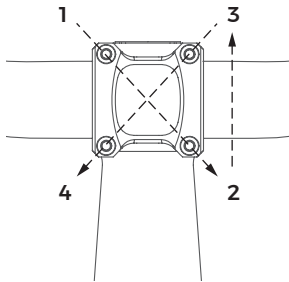

4 Tighten bolts to 5-6 Nm. Do not exceed handlebar manufacturer's specified torque.

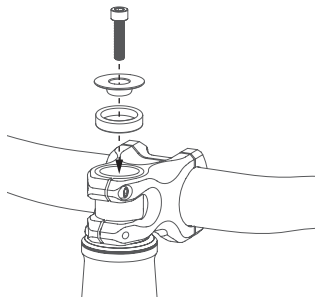

5 Install top cap according to the fork manufacturer's specifications.

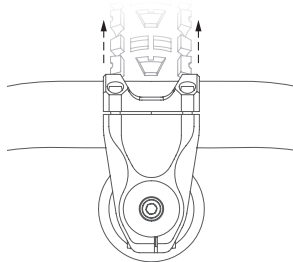

6 Ensure stem and bars are aligned with the front wheel.

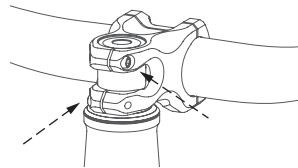

7 Tighten bolts to 5-6 Nm. Do not exceed fork manufacturer's specified torque.